

540a

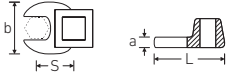

Crowfoot spanners

— Chrome Alloy Steel, chrome-plated



Product no.	$\frac{a}{8}$	$\frac{b}{8}$	L mm	b mm	a mm	S mm	$\frac{g}{g}$
01500024	$\frac{3}{8}$	$\frac{1}{4}$	25.5	19.8	6.3	14.6	17
02500028	$\frac{7}{16}$	$\frac{3}{8}$	32	22.2	6.3	17.2	34
02500032	$\frac{1}{2}$	$\frac{3}{8}$	34.3	25.4	6.3	18.1	37
02500034	$\frac{9}{16}$	$\frac{3}{8}$	37.7	30	6.3	20.9	40
02500036	$\frac{5}{8}$	$\frac{3}{8}$	37.7	30	6.3	20.4	44
02500038	$\frac{11}{16}$	$\frac{3}{8}$	42.5	38	6.3	24.1	62
02500040	$\frac{3}{4}$	$\frac{3}{8}$	42.5	38	6.3	24	66
02500042	$\frac{7}{8}$	$\frac{3}{8}$	42.3	38	6.3	24	59
02500044	$\frac{7}{8}$	$\frac{3}{8}$	44.5	41	6.3	25.8	65
02500048	1	$\frac{3}{8}$	47	45	8	26.7	78
02500050	$1\frac{1}{16}$	$\frac{3}{8}$	47	45	8	27.2	78
02500052	$1\frac{1}{8}$	$\frac{3}{8}$	50	50	8	28.5	84
02500054	$1\frac{3}{16}$	$\frac{3}{8}$	50	50	8	29.2	83
02500056	$1\frac{1}{4}$	$\frac{3}{8}$	53	57	8	30.3	101
02500058	$1\frac{5}{16}$	$\frac{3}{8}$	53	57	8	31.2	101
02500060	$1\frac{3}{8}$	$\frac{3}{8}$	54.5	60	8	32.3	105
02500062	$1\frac{7}{16}$	$\frac{3}{8}$	56.5	62	8	33.1	107
02500064	$1\frac{1}{2}$	$\frac{3}{8}$	58	65	8	34.5	118
02500065	$1\frac{9}{16}$	$\frac{3}{8}$	59.5	68	8	35.7	126
02500066	$1\frac{5}{8}$	$\frac{3}{8}$	63	70	8	37.3	140
02500067	$1\frac{11}{16}$	$\frac{3}{8}$	63	70	8	37.7	126
02500068	$1\frac{3}{4}$	$\frac{3}{8}$	68	76	8	40.4	161
02500070	$1\frac{7}{8}$	$\frac{3}{8}$	72	82	8	42	205
02500072	2	$\frac{3}{8}$	75	88	8	44.8	214
02500074	$2\frac{1}{8}$	$\frac{3}{8}$	75.6	91	10	46	265
02500076	$2\frac{1}{4}$	$\frac{3}{8}$	80.5	96	10	49.5	297
03500078	$2\frac{3}{8}$	$\frac{1}{2}$	81.5	96	8	51.3	214

* **Caution!** Adjust the setting on the torque wrench (see note on page 58 and 59)

540a HD



Crowfoot spanners heavy-duty

- for particularly high loads, e.g., stainless steel bolted joints
- full use of the open-ended spanner in combination with standard ratchets or torque wrenches with fixed square
- chrome-plated

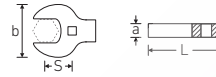

Product no.	$\frac{a}{8}$	$\frac{b}{8}$	L mm	b mm	a mm	S mm	$\frac{g}{g}$
02501024	$\frac{3}{8}$	$\frac{3}{8}$	39	26	11	24	56
02501028	$\frac{7}{16}$	$\frac{3}{8}$	40	26	11	25	56
02501032	$\frac{1}{2}$	$\frac{3}{8}$	42	30	11	25.8	64
02501034	$\frac{9}{16}$	$\frac{3}{8}$	43.4	32	11	26.8	52
02501036	$\frac{5}{8}$	$\frac{3}{8}$	45	34.8	11	27.7	58
02501038	$\frac{11}{16}$	$\frac{3}{8}$	47.2	38	11	28.6	69
02501040	$\frac{3}{4}$	$\frac{3}{8}$	49	41	11	29.6	94
02501042	$\frac{13}{16}$	$\frac{3}{8}$	51	46.4	11	30.5	113
02501044	$\frac{7}{8}$	$\frac{3}{8}$	52	48	11	31.3	99
02501046	$\frac{15}{16}$	$\frac{3}{8}$	54	51.2	11	32.3	129
02501048	1	$\frac{3}{8}$	56	53.4	11	33.2	133
02501050	$1\frac{1}{16}$	$\frac{3}{8}$	57	53.8	11	34.1	124
02501052	$1\frac{1}{8}$	$\frac{3}{8}$	59	53.8	11	35	128
02501054	$1\frac{3}{16}$	$\frac{3}{8}$	60	56	11	35.9	144
02501056	$1\frac{1}{4}$	$\frac{3}{8}$	62	60	11	36.8	153
02501058	$1\frac{5}{16}$	$\frac{3}{8}$	63	56	11	27.9	156
02501060	$1\frac{3}{8}$	$\frac{3}{8}$	65	62	11	38.7	178
02501062	$1\frac{7}{16}$	$\frac{3}{8}$	66.5	66	11	39.6	172
03501064	$1\frac{1}{2}$	$\frac{1}{2}$	76	70	16	45	310
03501069	$1\frac{13}{16}$	$\frac{1}{2}$	85	84	16	49.6	400
03501072	2	$\frac{1}{2}$	89	90	16	52.3	451
03501074	$2\frac{1}{8}$	$\frac{1}{2}$	91.5	92.8	16	54.2	460
03501075	$2\frac{3}{16}$	$\frac{1}{2}$	93	96	16	55.1	480
03501076	$2\frac{1}{4}$	$\frac{1}{2}$	95	99	16	56	500

* **Caution!** Adjust the setting on the torque wrench (see note on page 58 and 59)

TOOLS THAT
... inspire

447



Adaptors

- bi-hex with AS-Drive profile
- HPQ® high-performance steel, gunmetal finish

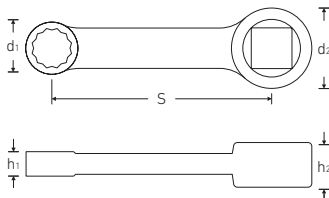

Product no.	mm	"	d ₁ mm	d ₂ mm	h ₁ mm	h ₂ mm	S mm	⊖ g
02181007	7	3/8	11.5	19	6	11	50.8	30
02181008	8	3/8	12.4	19	6	11	50.8	30
02181009	9	3/8	14	19	8	11	50.8	40
02181010	10	3/8	15.6	19	8	11	50.8	40
02181013	13	3/8	19.3	19	9.2	11	50.8	55

* **Caution!** Adjust the setting on the torque wrench (see note on page 58 and 59)

447a



Adaptors

- bi-hex with AS-Drive profile
- SAE AS 954-E
- HPQ® high-performance steel, gunmetal finish

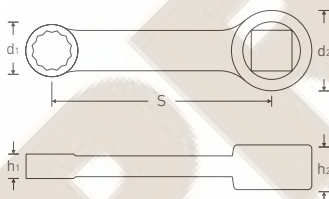

Product no.	mm	"	d ₁ mm	d ₂ mm	h ₁ mm	h ₂ mm	S mm	⊖ g
02470016	1/4	3/8	10.4	19	6	11	50.8	27
02470020	5/16	3/8	12.4	19	6	11	50.8	29
02470024	3/8	3/8	14.9	19	8	11	50.8	41
02470028	7/16	3/8	17	19	8	11	50.8	40
02470032	1/2	3/8	19	19	9.2	11	50.8	56
02470034	9/16	3/8	21	19	9.2	11	50.8	61
02470036	5/8	3/8	23	19	12	11	50.8	73

* **Caution!** Adjust the setting on the torque wrench (see note on page 58 and 59)

447aSP



Adaptors

- for external Spline-Drive screws
- MS-33787, MIL-W-8982
- HPQ® high-performance steel, gunmetal finish

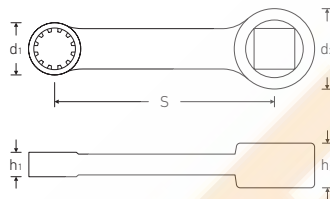

Product no.	mm	"	d ₁ mm	d ₂ mm	h ₁ mm	h ₂ mm	S mm	⊖ g
02480014	7/32	3/8	9.4	19	6	11	50.8	28
02480016	1/4	3/8	10.4	19	6	11	50.8	27
02480018	9/32	3/8	11.5	19	6	11	50.8	29
02480020	5/16	3/8	12.4	19	6	11	50.8	29
02480024	3/8	3/8	14.9	19	8	11	50.8	38
02480028	7/16	3/8	17	19	9.2	11	50.8	39
02480032	1/2	3/8	19	19	9.2	11	50.8	59
02480034	9/16	3/8	21	19	9.2	11	50.8	55
02480036	5/8	3/8	23	19	12	11	50.8	74

* **Caution!** Adjust the setting on the torque wrench (see note on page 58 and 59)

MADE IN CRONENBERG
MADE IN GERMANY

For more than 160 years, the STAHLWILLE brand has been synonymous with premium tools. From its foundation by Eduard Wille to the present day, our goal has always been the same: to manufacture tools that set the standard and that are 'Made in Germany'.

TORQUE MULTIPLIERS.

MP100-1500



Torque multiplier MULTIPOWER

- particularly compact design, lightweight and handy
- with ratchet function
- working angle 8°
- with angle of rotation scale
- to be used with a fixed 1/2" square torque wrench
- patented

- in carrying case
- accuracy ± 5%

Contains 5-pieces:

- 3 hex inserts: 30; 32; 36 mm
- 1 insert with 1" external square
- 1 reaction arm: L. 400 mm

Product no.	□	N-m ₁	ft-lb ₁	N-m ₂	ft-lb ₂	Gear ratio	Torque ratio	L mm	b mm	h mm	⊕ g	⊕ g with box
96531500	1/2	1500	1106	300	221	5.62 : 1	1 : 5	165	105	30	1890	3630

¹ output capacity max. ² input capacity max.

MP300



MP300-800

MP300-2000

MP300-5000

Torque multipliers MULTIPOWER

- easy transmission of the highest torques
- planetary gears with overload protection
- robust design for high torques up to 5,000 N-m/3,687 ft-lb
- up to 12,000 N-m/8,850 ft-lb available on request

- with anti-backlash protection (models 2,000 N-m onwards)
- with a spare sun wheel (overload protection)
- in carrying case
- accuracy ± 5%

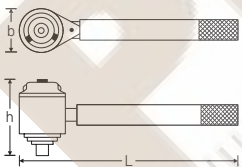

Product no.	Size	□	□	N-m ₁	ft-lb ₁	N-m ₂	ft-lb ₂	Gear ratio	Torque ratio	L mm	b mm	h mm	⊕ g	⊕ g with box
53030800	800	3/4	1/2	800	590	229	169	4 : 1	1 : 3.5	215	66	85	2000	5838
53031350	1350	3/4	3/4	1350	996	375	277	4 : 1	1 : 3.6	265	90	106	3400	7500
53032000 *	2000	1	1/2	2000	1475	160	118	16 : 1	1 : 12.5	330	95	161	7000	11000
53033000 *	3000	1	3/4	3000	2212	240	177	16 : 1	1 : 12.5	330	95	161	7000	10805
53035000 *	5000	1 1/2	3/4	5000	3687	294	217	20 : 1	1 : 17.0	400	120	180	10400	14000

* with anti-backlash protection ¹ output capacity max. ² input capacity max.

SR290-393

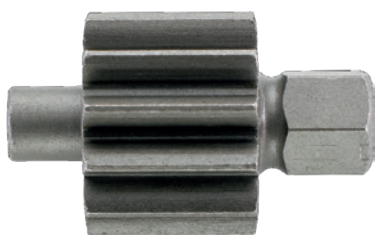

Sun wheels with overload protection

Product no.	Model	for model	Δ g
59030800	SR300-800	MP300-800	45
59031350	SR300-1350	MP300-1350	106
59032000	SR300-2000	MP300-2000	120
59033000	SR300-3000	MP300-3000	130
59035000	SR300-5000	MP300-5000	127
59300039	SR290N	STW 290N	18
59300067	SR295N	STW 295N	95
59300068	SR391N	STW 391N	95
59300069	SR392N	STW 392N	95
59300070	SR393N	STW 393N	105



SPARE PART SETS FOR RATCHETS AND RATCHET INSERT TOOLS.

4150QR



Spare parts set for ratchet

Contains 11-pieces:

1 pinion; 1 locking disc; 2 lever with pin; 1 ball; 2 compression springs; 2 retaining screws M 1.7 x 8; 2 cover plates

Product no.	for model	"	Content pcs.	△△ g
19011020	415QR, 725QR/4	1/4	11	24

4220

Spare parts set for ratchet

Contains 5-pieces:

1 pinion; 1 locking part; 1 switching disc; 1 spring; 1 screw

Product no.	for model	"	Content pcs.	△△ g
19020003	735/5	3/8	5	88

7250/4

Spare parts set for ratchet

Contains 9-pieces:

1 pinion; 1 pawl; 1 lever with pin; 1 ball; 2 compression springs; 2 retaining screws; 1 cover plate

Product no.	for model	"	Content pcs.	△△ g
19012021	725/4	1/4	9	26

7250B/4

Spare parts set for bit-ratchet

Contains 9-pieces:

1 pinion; 1 pawl; 1 lever with pin; 1 ball; 2 compression springs; 2 retaining screws; 1 cover plate

Product no.	for model	"	Content pcs.	△△ g
19012022	725B/4	1/4	9	21

7250B/5

Spare parts set for bit-ratchet

Contains 9-pieces:

1 pinion; 1 pawl; 1 lever with pin; 1 ball; 2 compression springs; 2 retaining screws; 1 cover plate

Product no.	for model	"	Content pcs.	△△ g
19012023	725B/5	5/16	9	48

4350QR



Spare parts set for ratchet

Contains 8-pieces:

1 pinion; 1 pawl; 1 lever with pin; 1 ball; 2 compression springs; 2 retaining screws

Product no.	for model	"	Content pcs.	△△ g
19020020	435QR, 725QR/5	3/8	8	51

7210/5

Spare parts set for ratchet

Contains 7-pieces:

1 ball; 1 pinion; 2 compression springs; 1 switch button; 1 switch lever pin; 1 locking disc

Product no.	for model	"	Content pcs.	△△ g
59191005	721/5, 721/5 Quick	3/8	7	53

7250L/5

Spare parts set for ratchet

Contains 9-pieces:

1 pinion; 1 pawl; 1 button with pin; 1 ball; 2 compression springs; 2 retaining screws; 1 cover plate

Product no.	for model	"	Content pcs.	△△ g
19021000	725L/5	3/8	9	70

7350/5

Spare parts set for ratchet

Contains 7-pieces:

1 pinion; 1 locking part; 1 switching disc; 1 spring; 3 screws

Product no.	for model	"	Content pcs.	△△ g
59251005	422, 735/5	3/8	7	85

5120QR



Spare parts set for ratchet

Contains 8-pieces:

1 pinion; 1 pawl; 1 lever with pin; 1 ball; 2 pressure springs; 2 retaining screws

Product no.	for model	"	Content pcs.	△△ g
19040020	512QR, 512SG-QR, 725QR/20	1/2	8	118

5150

Spare parts set for ratchet

Contains 5-pieces:

1 pinion; 1 locking piece, 1 countersunk screw, 1 switching disc,
1 switching spring

Product no.	for model	"	Content pcs.	△△ g
19040002	735/20	1/2	5	130

5120

Spare parts set for ratchet

Contains 8-pieces:

1 pinion; 1 pawl; 1 lever with pin; 1 ball; 2 pressure springs;
2 retaining screws

Product no.	for model	"	Content pcs.	△△ g
19040000	721/15, 721/15 Quick, 721/20, 721/20 Quick	1/2	8	127

7210/30

Spare parts set for ratchet

Contains 8-pieces:

1 ball; 1 pan head screw; 1 switching lever; 2 compression springs;
1 switch lever pin; 1 pawl; 1 pinion

Product no.	for model	"	Content pcs.	△△ g
59191030	721/30, 721/30 Quick	1/2	8	134

7250QR/10



Spare parts set for ratchet

Contains 8-pieces:

1 pinion; 1 pawl; 1 lever with pin; 1 ball; 2 pressure springs;
2 retaining screws

Product no.	for model	"	Content pcs.	△△ g
19041020	725QR/10	1/2	8	64

7350/10

Spare parts set for ratchet

Contains 7-pieces:

1 pinion; 1 locking part; 1 switching disc; 1 spring; 3 screws

Product no.	for model	"	Content pcs.	△△ g
59251010	735/10	1/2	7	96

7350/20

Spare parts set for ratchet

Contains 7-pieces:

1 pinion; 1 locking part; 1 switching disc; 1 spring; 3 screws

Product no.	for model	"	Content pcs.	△△ g
59251020	515, 735/20	1/2	7	140

7210/80

Spare parts set for ratchet

Contains 7-pieces:

1 pinion; 2 locking parts; 2 clamping pressure springs; 2 spring heads

Product no.	for model	"	Content pcs.	△△ g
59191080	721NF/80, 721NF/100, 735/80, 735/100	3/4	7	443

7350/40

Spare parts set for ratchet

Contains 7-pieces:

1 pinion; 1 locking part; 1 switching disc; 1 spring; 3 screws

Product no.	for model	"	Content pcs.	△△ g
59251040	735/40	3/4	7	219

7350/40HD-65

Spare parts set for ratchet

Contains 7-pieces:

1 pinion; 1 locking part; 1 switching disc; 1 spring; 3 screws

Product no.	for model	"	Content pcs.	△△ g
59251065	735/40HD; 735/65	3/4	7	429

MADE IN CRONENBERG
MADE IN GERMANY

For more than 160 years, the STAHLWILLE brand has been synonymous with premium tools. From its foundation by Eduard Wille to the present day, our goal has always been the same: to manufacture tools that set the standard and that are 'Made in Germany'.